

UNSHIELDED (DIP)TYPES

1.SHAPE AND DIMENSIONS(UNIT:mm)

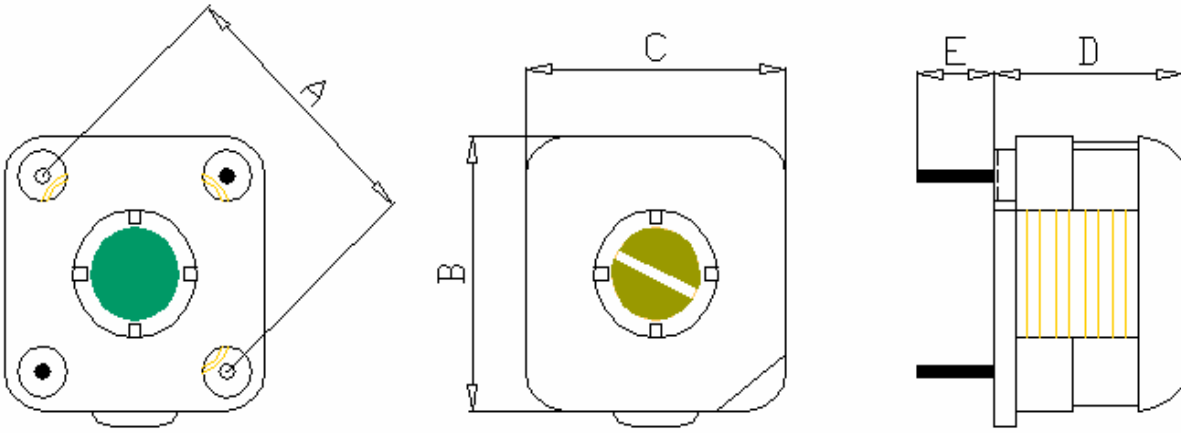

2.DIMENSIONS AND SPECIFICATIONS:

◆Using TH 2.6*2.5 CORE

$A\pm 0.3$	$B\pm 0.2$	$C\pm 0.2$	$D\pm 0.2$	$E\pm 0.5$
5.10	5.10	5.10	4.50	3.50

PART NO.	L(nH)min	L(nH)max	L(nH)nom	Q(min)
CR-0505U-1.5T-C	11.00	13.00	12.6±5%	80@100MHZ
CR-0505U-2.5T-C	20.00	22.00	21.2±5%	80@100MHZ
CR-0505U-3.5T-C	29.00	32.00	31.0±5%	60@100MHZ
CR-0505U-4.5T-C	42.00	46.00	44.5±5%	50@100MHZ
CR-0505U-5.5T-C	60.00	66.00	63.3±5%	40@100MHZ

- ◆Inductance and Q measurde By HP4191A with HP16092A as the test fixture
- ◆Inductance MAX is measured without core
- ◆As to core the soled The inductance MIN and MAX would rise