

### 1. SHAPE AND DIMENSION(UNIT:mm)

#### CRGL1303/1305/1311/1807

#### MOUNTING PAD

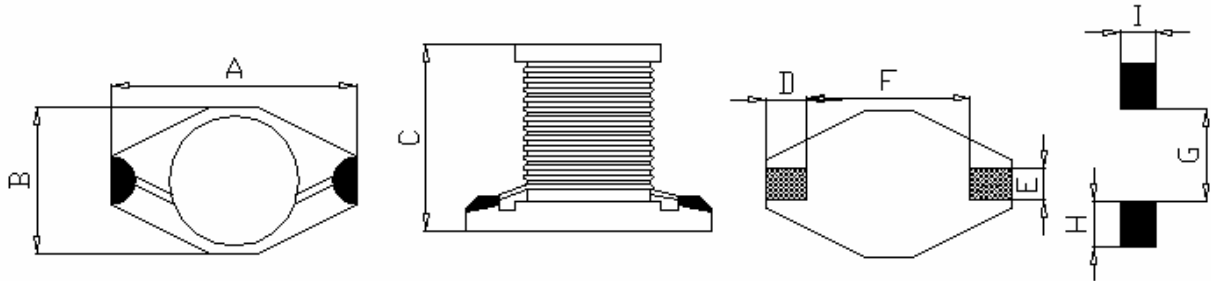

#### CRGL0603

#### MOUNTING PAD

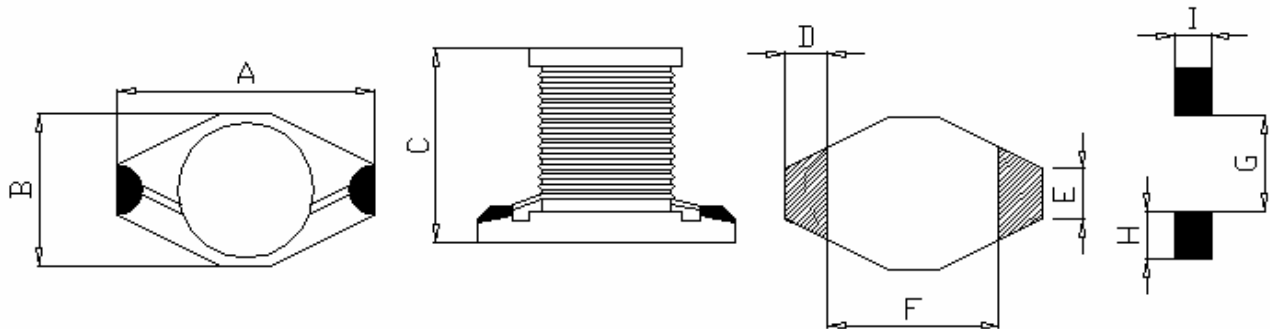

PART NO.	A(MAX)	B(MAX)	C(MAX)	D	E	F	G	H	I
CRGL0603	6.60	4.45	2.92	1.02	1.27	4.32	4.06	1.40	3.56
CRGL1303	12.95	9.40	3.00	2.54	2.54	7.62	7.37	2.92	2.79
CRGL1305	12.95	9.40	5.21	2.54	2.54	7.62	7.37	2.92	2.79
CRGL1311	12.95	9.40	11.43	2.54	2.54	7.62	7.37	2.92	2.79
CRGL1807	18.54	15.24	7.11	2.54	2.54	12.70	12.45	2.92	2.79

可立德實業有限公司

CLIDER ENTERPRISE CO., LTD.

## SPECIFICATIONS:

Part No.	L (uH)	DCR Max(Ohms)					Isat2(A)					Ims4(A)				
		CRGL	CRGL	CRGL	CRGL	CRGL	CRGL	CRGL	CRGL	CRGL	CRGL	CRGL	CRGL	CRGL	CRGL	CRGL
		0603	1303	1305	1311	1807	0603	1303	1305	1311	1807	0603	1303	1305	1311	1807
1R0M	1.0	0.05		0.01		0.01	2.90		9.00		20.0	2.90		6.80		8.60
1R5M	1.5	0.05		0.01			2.60		8.00			2.80		6.40		
2R2M	2.2	0.07		0.01		0.01	2.30		7.00		16.0	2.40		6.10		7.10
3R3M	3.3	0.08		0.02		0.02	2.00		6.40		14.0	2.00		5.40		6.20
4R7M	4.7	0.09		0.02			1.50		5.40			1.50		4.80		
5R6M	5.6					0.02					12.0					5.30
6R8M	6.8	0.13		0.03			1.20		4.60			1.40		4.40		
100M	10	0.16	0.11	0.04	0.04	0.03	1.10	2.40	3.80	8.00	10.0	1.10	2.00	3.90	3.50	4.30
150M	15	0.23	0.15	0.05	0.05	0.04	0.90	2.00	3.00	7.00	8.00	1.20	1.50	3.10	3.00	4.00
220M	22	0.37	0.23	0.09	0.07	0.05	0.70	1.60	2.60	5.50	7.00	0.80	1.30	2.70	2.50	3.50
330M	33	0.51	0.30	0.10	0.08	0.07	0.58	1.40	2.00	4.00	5.50	0.60	1.10	2.10	2.00	3.00
470M	47	0.64	0.39	0.14	0.11	0.09	0.50	1.00	1.60	3.80	4.50	0.50	0.80	1.80	1.60	2.60
680M	68	0.86	0.66	0.20	0.17	0.13	0.40	0.90	1.40	3.00	3.50	0.40	0.70	1.50	1.20	2.30
101M	100	1.27	0.84	0.28	0.22	0.19	0.31	0.70	1.20	2.50	3.00	0.30	0.60	1.30	1.20	1.80
151M	150	2.00	1.20	0.40	0.34	0.25	0.27	0.60	1.00	2.00	2.60	0.25	0.50	1.00	0.90	1.50
221M	220	3.11	1.90	0.61	0.44	0.38	0.22	0.50	0.80	1.60	2.40	0.20	0.40	0.80	0.70	1.20
331M	330	3.80	2.70	1.02	0.70	0.56	0.18	0.40	0.60	1.20	1.90	0.16	0.30	0.60	0.60	1.00
471M	470	5.06	4.00	1.27	0.95	0.85	0.16	0.30	0.50	1.00	1.40	0.15	0.20	0.50	0.30	0.82
681M	680	9.20	5.30	2.02	1.20	1.10	0.14	0.20	0.40	1.00	1.20	0.12	0.10	0.40	0.20	0.72
102M	1000	13.8	8.40	3.00	2.00	1.80	0.10	0.10	0.30	0.80	1.00	0.07	0.05	0.30	0.10	0.56

- ◆ Tested at 100 KHz, 0.1 Vrms.
- ◆ Inductance drop = 10% typ. at rated Isat.
  - (a) CRGL0603 : For 15°C temperature rise typ. At Irms.
  - (b) CRGL1303 : For 30°C temperature rise typ. At Irms.
  - (c) CRGL1305 : For 40°C temperature rise typ. At Irms.
  - (d) CRGL1807 : For 40°C temperature rise typ. At Irms.
  - (e) CRGL1311/CRGL1807 : For 20°C temperature rise typ. At Irms.
- ◆ Operating temperature range -40°C to + 85°C.
- ◆ Electrical specifications at 25°C.
- ◆ Inductance : uH ± 20% (M).

可立德實業有限公司

**CLIDER ENTERPRISE CO., LTD.**